

Part #: 200302C

A/W#: 200303C

Art size: 16" x 5.25"

Fold size: 4" x 5.25"

Color: 1/1 Black

Paper Stock: 65lb. Finch White Opaque Vellum Cover

Fold

Fold

Fold

TUFFSET™ CT SWITCH USER GUIDE

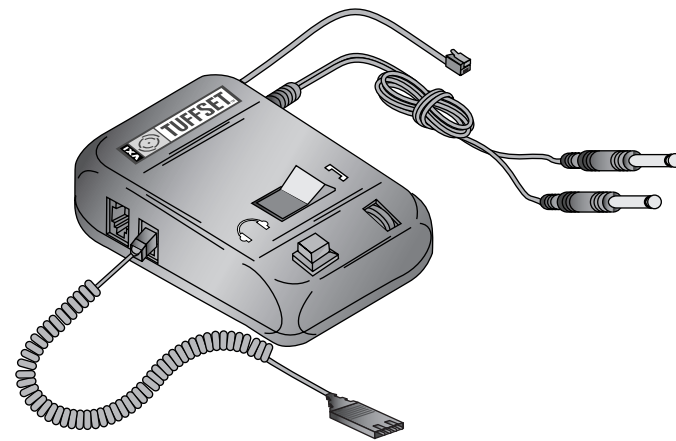

1 CONNECT THE TUFFSET CT SWITCH TO YOUR PC AND TELEPHONE

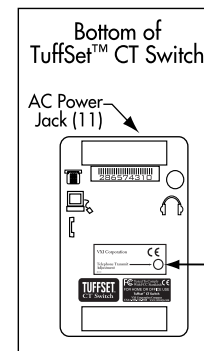
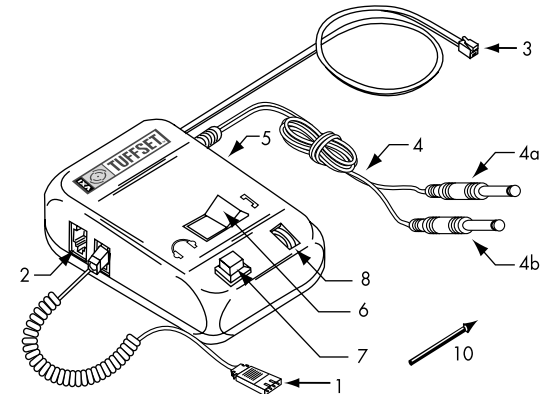

- 1 - Quick Disconnect
- 2 - Footswitch Jack
- 3 - Patch Cord to Telephone
- 4 - PC Sound Card Cord
 - 4a - Red Plug - Microphone
 - 4b - Black Plug - Speaker
- 5 - Handset Jack
- 6 - Headset/Handset Switch
- 7 - Computer/Telephone Selector
- 8 - Receive Volume Control
- 9 - Transmit Volume Adjust
- 10 - Transmit Adjust Tool
- 11 - AC Power Jack (Rear of Unit)

The VXi TuffSet™ CT Switch, in conjunction with a TuffSet Headset, enables seamless switching between computer-based tasks and telephone use with the push of the yellow button. In addition, the Computer/Telephone Selector button allows the user to talk to the computer and listen to the person on the telephone simultaneously.

(Numbers) refer to the TuffSet CT Switch Components drawing and list at left.

A. Insert the AC Adapter Cord into the AC Power Jack on the rear of the Switch (11), and plug the Adapter into an AC outlet. Make sure the Adapter Cord plug is fully inserted into the Jack.

B. Remove the handset cord from your telephone. Insert the handset cord into the Telephone Handset Jack (5).

C. Insert the free end of the Telephone Patch Cord

(3) into your telephone where the handset cord was removed.

D. Insert the Quick Disconnect Connector on the coiled cord (1) into the Quick Disconnect on the headset. Verify that the other end of the coiled cord is inserted into the Headset Jack on the Switch.

E. Insert the Red plug (4a) on the Sound Card Cord into the microphone input jack on your computer's sound card.

F. Insert the Black plug (4b) on the Sound Card Cord into the speaker output jack on your computer's sound card.

G. If necessary, adjust your Windows Volume Control Panel to a comfortable level.

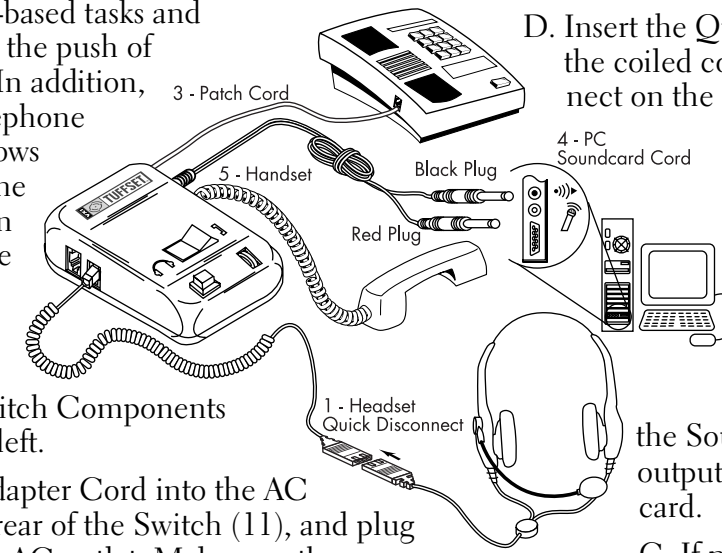

Fold

Fold

Fold

Fold

Fold

Fold

2 NORMAL OPERATION

A. Press the left side of the Headset/Handset switch (6) to select the headset.

B. Remove your telephone handset from your phone and make a call.

C. Adjust the Receive Volume (8) to a comfortable listening level.

D. If necessary, adjust the Telephone Transmit Volume Control (9) (located on the underside of unit) with the small adjustment tool (10) provided:

If the other person cannot hear you, gently turn the gain control clockwise.

To reduce the sensation of hearing your own voice in your earpiece, gently turn the gain control counterclockwise as you speak.

E. To dictate to your computer, depress the

yellow locking Computer/Telephone Selector button (7). This redirects the microphone signal from the telephone to the computer. While dictating you will be able to hear the person speaking on the telephone, but the person on the telephone will not hear you. To talk on the telephone, press and release the yellow button.

F. To use the telephone handset, press the right side of the Headset/Handset switch (6).

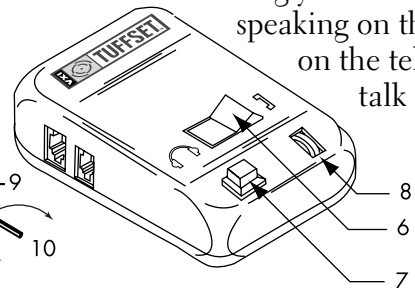
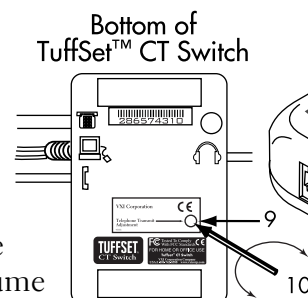

Operation with the Optional Footswitch

An optional footswitch is available, which can be plugged in to the TuffSet CT Switch allowing hands-free switching between computer/telephone. For more information, please call 1-800-742-8588.

Fold

Fold

Fold

VXI LIMITED WARRANTY

1. If your VXI Tuffset™ CT Switch fails to work for any reason during the first two years from the date of purchase as shown by the purchaser's warranty registration, VXI will repair or replace the switch, at its election, free of charge. Without warranty registration, the warranty period begins on the date of manufacture. All products returned to VXI after the two-year warranty period will be repaired as "out of warranty" products, and purchaser will be billed for such repairs pursuant to the Out-of-Warranty Repair provisions set forth below.

2. The obligations of VXI under this warranty shall be limited to repair or replacement (at our option) of any part returned, freight prepaid to VXI.

Returned products require a Return Authorization that may be requested from VXI at 800-742-8588 or www.vxicorp.com.

3. THIS LIMITED WARRANTY IS IN LIEU OF ALL OTHER WARRANTIES, EXPRESS OR IMPLIED, INCLUDING THE IMPLIED WARRANTIES OF MERCHANTABILITY AND FITNESS FOR A PARTICULAR PURPOSE.

Some jurisdictions do not permit the exclusion of implied warranties and the foregoing exclusions may not apply to you.

4. In no event shall VXI be responsible for any other damages whatsoever including direct, indirect, special, incidental, consequential or otherwise for breach of this or any other warranty, express or implied.

5. Products returned to VXI for Out-of-Warranty repairs, freight prepaid and with proper Return Authorization, will be returned to the customer at VXI's expense within five (5) days of VXI's receipt of payment.

OUT-OF-WARRANTY REPAIRS

VXI will repair out-of-warranty headsets for a charge of \$22.50 each (or such other charge as may be applicable as of the date of receipt by VXI). See return details above. Out-of-warranty repairs are warranted to be free from defects in material and workmanship for ninety (90) days.



If you have headset questions, please contact:
VXI Corporation Technical Support (800) 742-8588
Headquarters (603) 742-2888
email parrott@vxicorp.com
website www.vxicorp.com

All trademarks are the property of their respective owners.
P/N 200302C ©2001 VXI CORPORATION

Fold

Fold

Fold